

## Oil Pan and Oil Pump Strainer Removal and Installation

S5JB0A1526002

### Removal

- 1) Remove oil level gauge.
- 2) Raise vehicle.
- 3) Remove engine under cover (1).
- 4) Drain engine oil by removing drain plug (2).

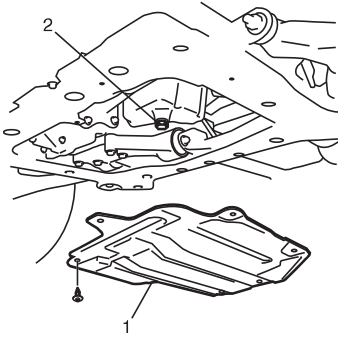

I5JB0A152005-01

- 5) Remove front suspension frame referring to "Front Suspension Frame, Stabilizer Bar and/or Bushings Removal and Installation in Section 2B".
- 6) Remove oil pan, oil pump strainer (1) and O-ring (2) from lower crank case.

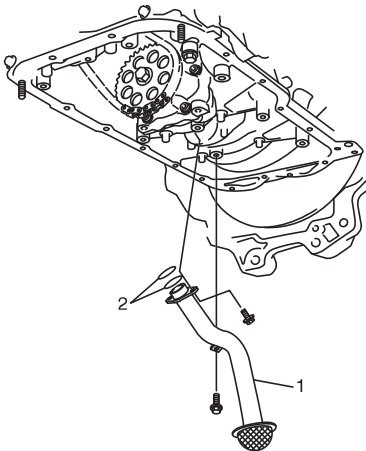

I5JB0A152006-02

### Installation

- 1) Apply sealant to oil pan (1) mating surface continuously as shown in figure.

**"A": Water tight sealant 99000-31250 (SUZUKI Bond No.1207F)**

#### Sealant amount for oil pan

**Width "a": 3 mm (0.12 in.)**

**Height "b": 2 mm (0.08 in.)**

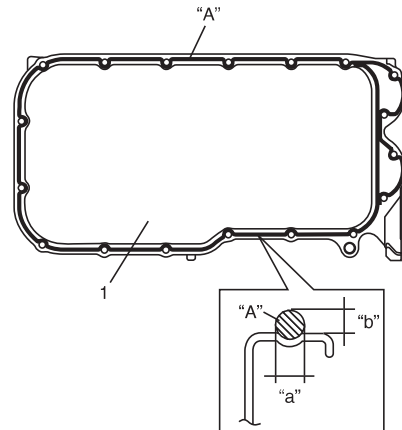

I5JB0A152007-01

- 2) Install new O-rings (2) to oil pump strainer (1) securely as shown in figure. Tighten strainer bolts to specified torque.

#### Tightening torque

**Oil pump strainer bolt (a): 11 N·m (1.1 kgf-m, 8.0 lb-ft)**

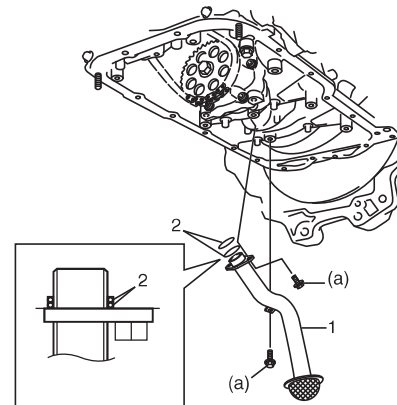

I5JB0A152008-02

- 3) After fitting oil pan (1) to cylinder block, run in securing bolts and start tightening at the center: move wrench outward, tightening one bolt at a time. Tighten bolts and nuts to specified torque.

#### Tightening torque

**Oil pan bolt and nut (a): 11 N·m (1.1 kgf-m, 8.0 lb-ft)**

**Transmission case No.1 bolt (b): 85 N·m (8.5 kgf-m, 61.5 lb-ft)**