

## ADJUSTMENTS (Continued)

- (4) Slide cable eyelet off transmission shift lever.
- (5) Verify transmission shift lever is in Park detent by moving lever fully rearward. Last rearward detent is Park position.
- (6) Verify positive engagement of transmission park lock by attempting to rotate propeller shaft. Shaft will not rotate when park lock is engaged.
- (7) Slide cable eyelet onto transmission shift lever.
- (8) Lower vehicle and check engine starting. Engine should start only in Park and Neutral.
- (9) Lock shift cable by pressing cable adjuster clamp down until it snaps into place.

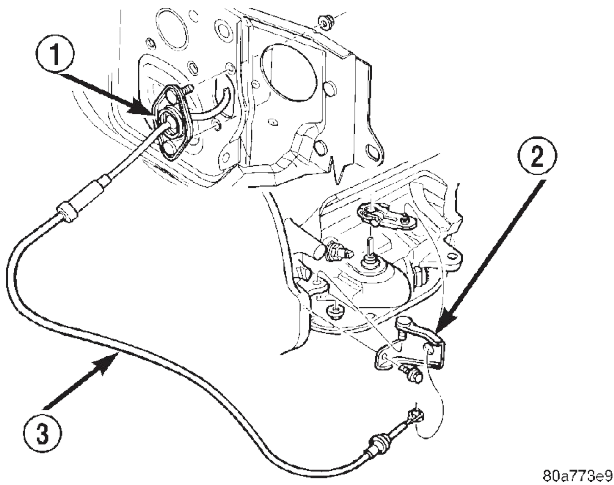

**Fig. 307 Gearshift Cable Routing**

- 1 - CABLE MOUNTING
- 2 - CABLE BRACKET AT TRANS.
- 3 - GEARSHIFT CABLE

## BAND ADJUSTMENTS

### FRONT BAND ADJUSTMENT

The front (kickdown) band adjusting screw is located on the left side of the transmission case above the manual valve and throttle valve levers.

- (1) Raise vehicle.
- (2) Loosen band adjusting screw locknut (Fig. 308). Then back locknut off 3-5 turns. Be sure adjusting screw turns freely in case. Apply lubricant to screw threads if necessary.
- (3) Tighten band adjusting screw to 8 N·m (72 in. lbs.) torque with Inch Pound Torque Wrench C-3380-A, a 3-in. extension and appropriate Torx™ socket.

**CAUTION:** If Adapter C-3705 is needed to reach the adjusting screw, tighten the screw to only 5 N·m (47-50 in. lbs.) torque.

- (4) Back off front band adjusting screw 3 turns.
- (5) Hold adjuster screw in position and tighten locknut to 41 N·m (30 ft. lbs.) torque.

- (6) Lower vehicle.

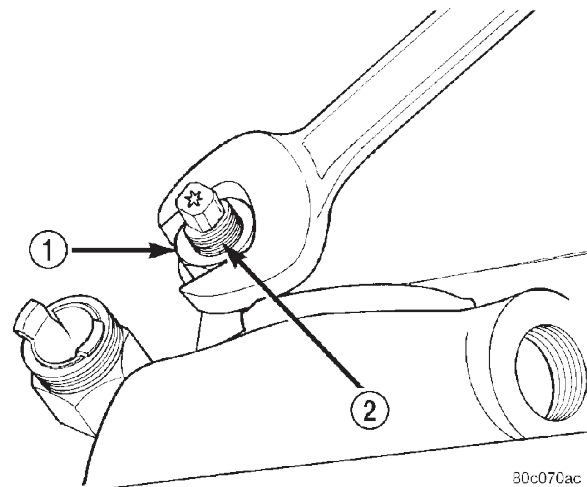

**Fig. 308 Front Band Adjustment Screw Location**

- 1 - LOCK-NUT
- 2 - FRONT BAND ADJUSTER

### REAR BAND ADJUSTMENT

The transmission oil pan must be removed for access to the rear band adjusting screw.

- (1) Raise vehicle.
- (2) Remove transmission oil pan and drain fluid.
- (3) Loosen band adjusting screw locknut 5-6 turns (Fig. 309). Be sure adjusting screw turns freely in lever.
- (4) Tighten adjusting screw to 8 N·m (72 in. lbs.) torque.

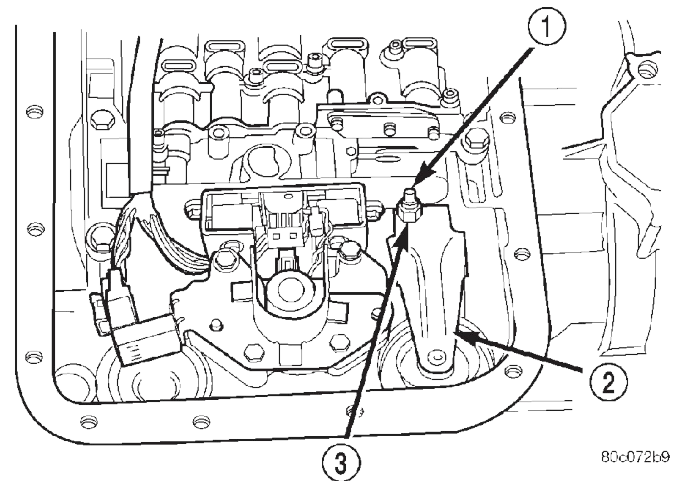

**Fig. 309 Rear Band Adjusting Screw Location**

- 1 - ADJUSTING SCREW
- 2 - REAR BAND LEVER
- 3 - LOCKNUT

- (5) Back off adjusting screw 4 turns.
- (6) Hold adjusting screw in place and tighten locknut to 34 N·m (25 ft. lbs.) torque.