

# SUSPENSION - REAR

1998 Mitsubishi Montero

1997-98 SUSPENSION  
Rear - RWD & 4WD

Montero, Montero Sport

## DESCRIPTION

NOTE: For testing and diagnosis information on electronically controlled shocks, see ELECTRONIC - Montero article.

Montero

Rear suspension system is multi-link type with shock absorbers, coil springs, lateral rod and stabilizer bar. See Fig. 2.

Montero Sport

Rear suspension system is a leaf spring type with shock absorbers and stabilizer bar. See Fig. 2.

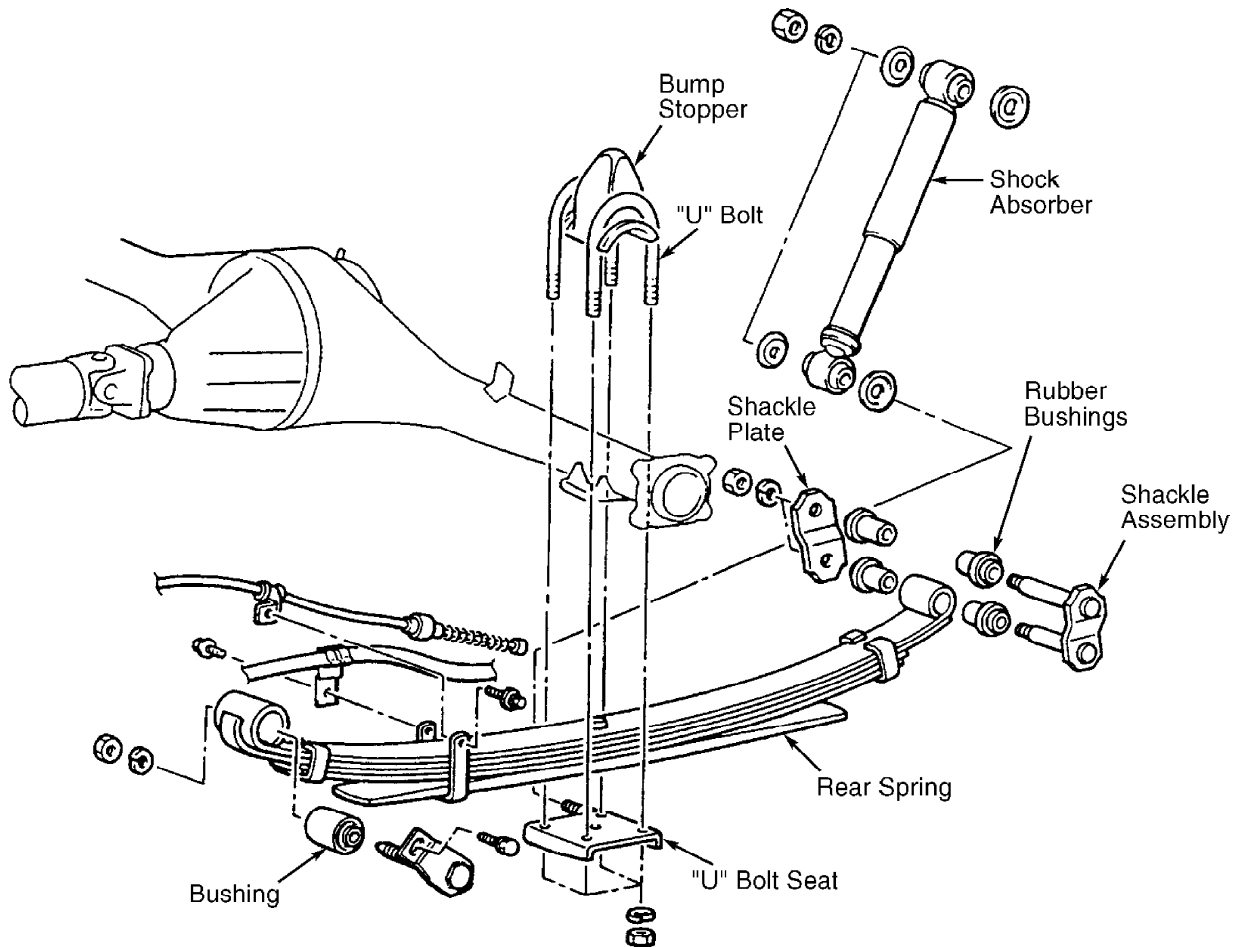

98H12846

Fig. 1: Exploded View Of Rear Suspension (Montero Sport)  
Courtesy of Mitsubishi Motor Sales of America.

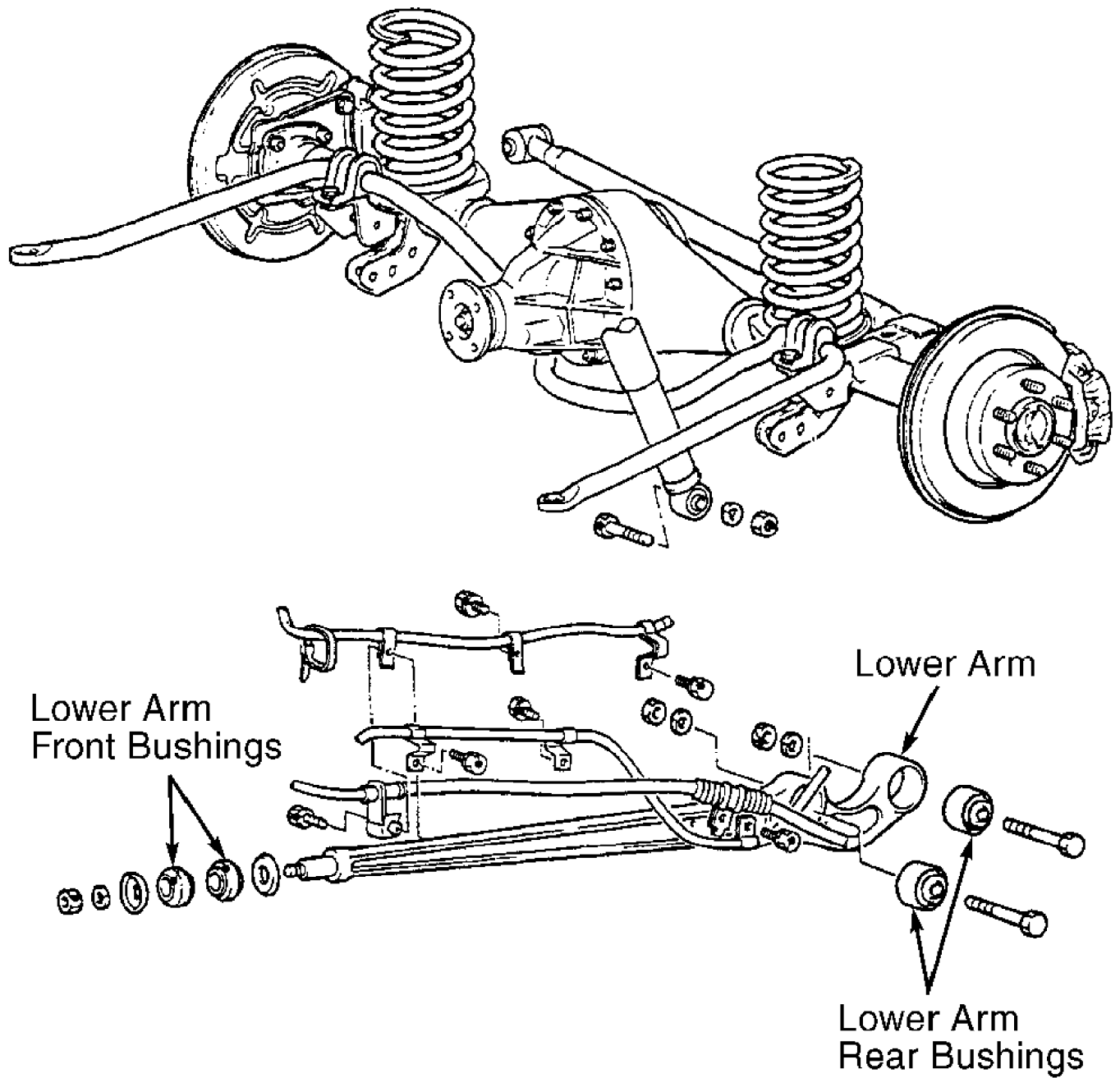

98G12845

Fig. 2: Exploded View Of Rear Suspension (Montero)  
 Courtesy of Mitsubishi Motor Sales of America.

## ADJUSTMENTS & INSPECTION

### WHEEL ALIGNMENT SPECIFICATIONS & PROCEDURES

NOTE: Wheel alignment is factory set and cannot be adjusted.

## REMOVAL & INSTALLATION

## REAR SUSPENSION ASSEMBLY

NOTE: Procedures for Montero are for lateral rod, coil springs and lower arms only. Procedures for Montero Sport are for leaf springs only.

### Removal (Montero)

1) Raise and support rear of vehicle. Place a jack under center of rear axle housing. Remove parking brake cable attaching bolts.

2) Remove rear speed sensor attaching bolt (if equipped). Remove rear axle housing lock position harness attaching bolt and lower shock bolts.

3) Remove lateral rod bolts and remove lateral rod. Remove lower arm rear bolts. Remove lower arm front mounting nut and remove lower arm. See Fig. 2.

### Inspection

Check lateral rod for straightness and damage. Check rubber bushings for deterioration, cracks and wear.

### Installation

If lateral rod bushings need replacing, remove and install using Lower Arm Bushing Arbor (MB990650). Apply a sufficient amount of liquid soap to bushings when installing them into lateral rod. If lower arm rear bushings need replacing, remove and install rear bushings using Rear Bushing Arbor (MB991293). To complete installation, reverse removal procedure. Tighten all suspension fasteners to specification with vehicle on ground and suspension unloaded. See TORQUE SPECIFICATIONS.

### Removal (Montero Sport)

1) Raise and support rear of vehicle. Place a jack under center of rear axle housing.

2) Disconnect parking brake cable attaching bolts. Remove rear speed sensor attaching bolt. Remove rear shock nuts and washers. Remove rear shocks.

NOTE: The yellow shock mounts on left side and the pink one mounts to the right side of vehicle.

3) Remove U-bolt nuts, U-bolt seat and U-bolts. Remove bump stopper. Remove rear shackle plate nuts, shackle plate, bushings and shackle assembly. Remove front shackle nuts and bolts. Remove leaf spring. See Fig. 1.

### Inspection

Check leaf springs for cracks and other damage. Inspect all components and bushings for damage and wear. Replace components as necessary.

### Installation

To install, reverse removal procedure. Ensure shocks are installed on proper side of vehicle. Tighten all suspension fasteners to specification with vehicle on ground and suspension unloaded. See TORQUE SPECIFICATIONS.

## SHOCKS

### Removal

1) Raise and support rear of vehicle. Place a jack under center of rear axle housing. On Montero remove shock actuator (if equipped).

2) Remove upper shock mounting nuts and washers. On Montero remove shock lower mounting nuts and bolts. On Montero Sport remove shock lower mounting nuts and washers. Remove shock assembly.

#### Inspection

Check shock for oil leakage, abnormal noise and poor function. Check coil spring for bending and weakness. Check rubber parts for deterioration and cracks.

#### Installation

To install, reverse removal procedure. Tighten all fasteners to specification. See TORQUE SPECIFICATIONS.

## STABILIZER BAR

#### Removal

Raise and support vehicle. Support rear suspension assembly using a jack. On Montero remove shock lower mounting bolts and nuts. Remove stabilizer bar bracket and bushings. Remove stabilizer link mounting nut and bolt. Remove stabilizer link joint cups, bushings and collar. Remove stabilizer bar.

#### Inspection

1) Check bushings for wear and deterioration. Check stabilizer bar, stabilizer link and all bolts for damage and wear. Replace components as necessary.

#### Installation

To install, reverse removal procedure. When installing stabilizer link, hold link using wrench and tighten nut until distance from end of bolt to edge of nut is .59-.70" (15-17 mm). Tighten all fasteners to specification. See TORQUE SPECIFICATIONS.

## TORQUE SPECIFICATIONS

### TORQUE SPECIFICATIONS

Application	Ft. Lbs. (N.m)
Upper Shock Nut	
Montero .....	11 (15)
Montero Sport .....	16 (22)
Lower Shock Nut And Bolt	
Montero .....	159-181 (216-245)
Montero Sport .....	16 (22)
Lateral Rod Nut And Bolt	
Montero .....	170 (230)
Lower Arm Rear Nut And Bolt	
Montero .....	170 (230)
Lower Arm Front Nut	
Montero .....	101 (137)
Leaf Spring Rear Shackle Nut	
Montero Sport .....	38 (52)
Leaf Spring Front Shackle Nut And Bolt	
Montero Sport .....	145 (196)
"U" Bolt Nut	
Montero Sport .....	72-87 (98-118)
Stabilizer Bar Bracket Bolt	25-26 (34-35)