

STEERING LOCK STOPS

Service repair no - 57.65.03

Check

1. Measure clearance between tyre wall and radius arm at full lock. This must be not less than 20 mm.

Adjust

2. Loosen stop bolt locknut.
3. Turn stop bolt as required.
4. Tighten locknut.
5. Check clearance between tyre wall and radius arm on each lock.



NOTE: Alternatively lock stop adjustment may be carried out using following procedure.

Check

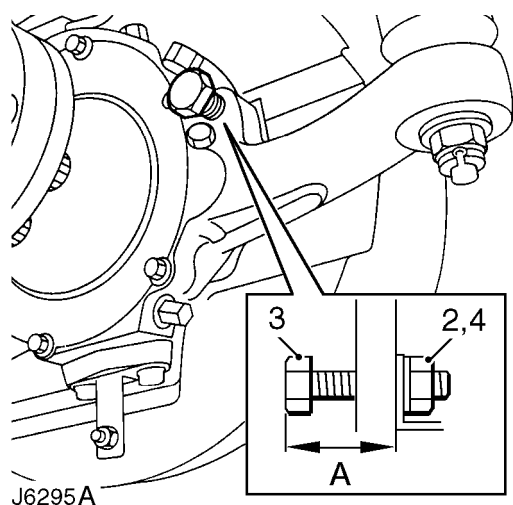

1. Measure stop bolt protrusion 'A'. Refer to table for correct setting.

Adjust

2. Loosen stop bolt locknut.
3. Turn stop bolt as required.
4. Tighten locknut.
5. Check wheel position at full lock.

LOCK STOP SETTINGS

Tyre & wheel size - alloys

Make	Size	Setting
BF Goodrich Mud Terrain	265	59,7 mm
Goodyear GT+4	235	55,7 mm
Michelin M+S 4x4	235	54,2 mm

Tyre & wheel size - steel

Make	Size	Setting
Goodyear	205	52,2 mm
Michelin	205	52,2 mm
Avon	7.50	56 mm
Michelin	7.50	56 mm
Goodyear	7.50	56 mm