

NEW FOR 2007...PRO COMP JEEP!



If hardcore Jeep enthusiasts had it their way, every commute would have some of the Moab Rim, Sledgehammer or their own trail thrown in to separate the serious rigs from the others.

Pro Comp Suspension is committed to increasing the off-road performance of the 97-06 Jeep TJ/LJ/Rubicon and here is the collection of goodies to do it.



New “Boxed” Lower Control Arms
New boxed lower control arms increase weld area around the bushing eyelet for improved strength. There are now specific front and rear arms that can be mounted traditionally with the bend down or upside down for improved break-over angles. The front arms are formed to eliminate tire scrub at steering lock. Sold in pairs. Included in our latest Stage II 4” TJ/LJ lift system for 2003-’06 models.

Part No.	Description
55200	97-06 TJ / LJ / 84-01 XJ / 93-98 ZJ Front Lower Arms
55400	97-06 TJ / LJ Rear Lower Arms



New Adjustable Upper Control Arms
New adjustable upper arms are available to fine tune front caster angles. Adjustable rear arms allow rear pinion angle tuning for use with or without a CV rear driveshaft and transfer case tail shaft kit.

Part No.	Description
55100	97-06 TJ / LJ Adjustable Front Upper Arms
55700	97-06 TJ / LJ Adjustable Rear Upper Arms



TJ Sway Bar Disconnects 3”-5” Lift
These sensible and simple sway bar end links are the key to maximum off-road articulation. Simply remove the lower retaining pin, disconnect the links and fasten them to retention clips placed on the sway bar. No loose or dangling parts to worry about. Don’t forget to reconnect for optimum on road performance.

Part No.	Description
55506	97-06 T J / LJ

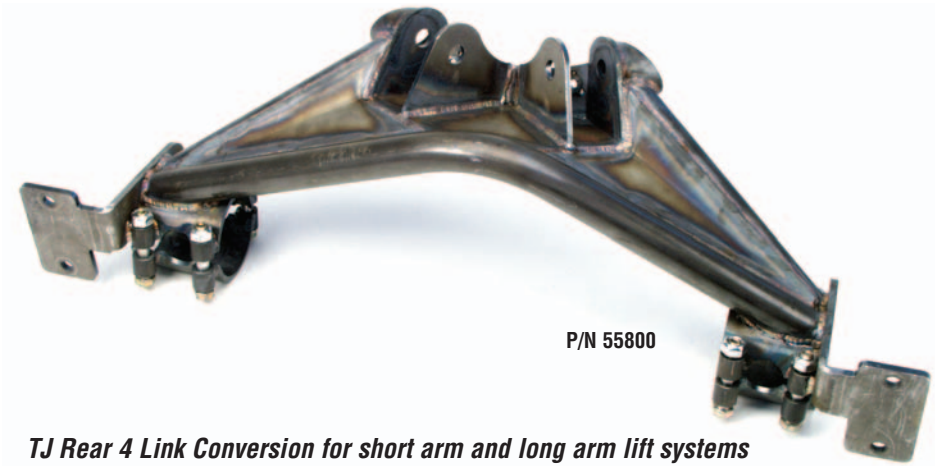

TJ Rear 4 Link Conversion for short arm and long arm lift systems
This fabricated rear axle truss comes complete with specially designed upper arms to create ideal four-link geometry. This bolt on 4-link conversion eliminates the factory rear track bar, allows maximum articulation and eliminates torque steer inherent in a lifted Jeep TJ. Take advantage of superior off-road articulation, excellent on road handling and increased durability. Exhaust modification required for installation. Extended brake lines required (If extended sway bar links are not being used they will be required for 3-5 inch lift systems).

Part No.	Description
55800	TJ / LJ 4 Link Conversion



TJ Front Track Bar Bracket
This crafted heavy duty track bar bracket lowers the track bar mounting point by 3” to preserve the factory steering and suspension operating angles. This bracket combined with the JTB400 adjustable track bar and YJ400 pitman increases suspension travel and eliminates bump steer.

Part No.	Description
55300	97-06 TJ / LJ

Adjustable Front Track Bar
Pro Comp Suspension’s high quality adjustable track bar is a trail smart upgrade for any system with 2” – 5” suspension lifts. This adjustable track bar keeps the front axle of a lifted Jeep in the correct location to reduce bump steer and to keep the vehicle tracking down the road straight. Manufactured from U.S. 4130 chromoly tubing and includes an aircraft quality high angle rod end for the frame mount. Grade 8 hardware and durable urethane bushings complete this U.S. made suspension upgrade.

Part No.	Description
JTB400	97-06 TJ / LJ / 84-01 XJ / 93-98 ZJ

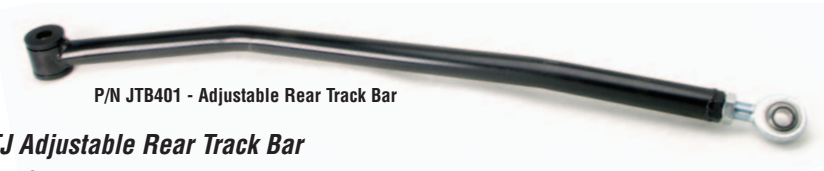

TJ Adjustable Rear Track Bar
Pro Comp has the proper solution for accurate location of the rear axle and changes in pinion angle when a tail shaft kit and CV driveshaft are installed; P/N JTB401 adjustable rear track bar is made of 4130 chromoly tubing like our front track bars and uses the same aircraft quality high angle rod end to allow full articulation.

Part No.	Description
JTB401	97-06 TJ / LJ

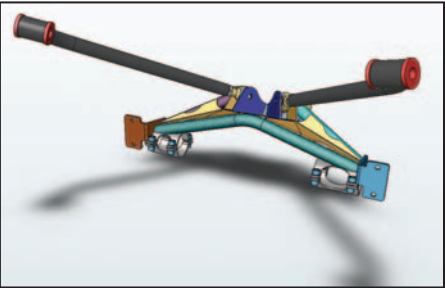

TJ Steering Box Protector
Way better than a pocket protector. This 3/16” thick custom fabricated steering box guard will prevent any harm to the hardware that allows enthusiasts with boulders on the brain to steer their TJ into or onto large immovable objects.

Part No.	Description
55500	97-06 TJ / LJ



Hot Options!



see pages 100-108

Important Ordering Notes

JEEP TJ WRANGLER

				Complete Kit	Kit Breakdown (included in complete kit)			Kit breakdown continued		OPTIONAL EQUIPMENT							
Year	Application	Front / Rear Ride Height (2)	Recommended Tire Size	ES Series or MX6 Shocks	Front / Rear Kit	Front Coils	Rear Coils	Front Shocks x2	Rear Shocks x2	Front Adj. Track Bar	Frt. Track Bar Bracket	Rear Adjustable Track Bar	Lower Arm Bushing Set	Rear Pinion Cams	Front Alignment Cams	Frt. Sway Bar Disconnects	Steering Stabilizer
97-06	TJ Wrangler / Rubicon	1.5" / 1.5"	31"x10.50"	K3054 ^(3,6) K3054MX ^(3,6)	55415 55415	Spacer Spacer	Spacer Spacer	321515 MX6028	321500 MX6029	———— ————	———— ————	———— ————	———— ————	20-65225 ————	20-65226 ————	55506 55506	219200 219200
97-06	TJ Wrangler / Unlimited	2.0" / 2.0"	32"x11.50"	K3055 ^(3,6) K3055MX ^(3,6)	———— ————	55297 55297	55298 55298	321515 MX6093	321500 MX6094	JTB400 JTB400	———— ————	JTB401 JTB401	———— ————	20-65225 20-65225	20-65226 20-65226	55506 55506	219200 219200

JEEP TJ WRANGLER STAGE II 4WD NEW PRODUCT!

03-06	TJ Wrangler / Rubicon	4.0" / 4.0"	33"x12.50"	K3083B K3083BMX	55699B 55699BMX	55497	55498	324515 MX6021	324509 MX6023	Included Included	Included Included	JTB401 JTB401	90-6048 90-6048	20-65225 20-65225	20-65226 20-65226	Included Included	219200 219200
97-02	TJ Wrangler	4.0" / 4.0"	33"x12.50"	K3057B (3,5,7) K3057BMX (3,5,7)	55499B (1) 55499B (1)	55497	55498	324515 MX6021	324509 MX6023	Cross-Link Design	Bolt Together Components	JTB401 JTB401	90-6048 90-6048	20-65225 20-65225	20-65226 20-65226	55506 55506	219200 219200

JEEP TJ WRANGLER STAGE I 4WD

03-06	TJ Wrangler / Rubicon w/hard top w/soft top	4.0" / 4.0"	33"x12.50"	K3076B (3,5,7) K3077BMX (3,5,7) K3078BMX (3,5,7)	55695B 55695B 55695B	55497	55498	324515 MX6021 MX6021	323509 MX6023 MX6106	JTB400 JTB400 JTB400	55300 55300 55300	JTB401 JTB401 JTB401	90-6048B 90-6048B 90-6048B	20-65225 20-65225 20-65225	20-65226 20-65226 20-65226	55506 55506 55506	219200 219200 219200
04-06	Wrangler Unlimited/ Rubicon	4.0" / 4.0"	33"x12.50"	K3084B (3,5,7) K3084BMX (3,5,7)	55695B 55695B	55497	55404	324515 MX6021	323509 MX6023	JTB400 JTB400	55300 55300	JTB401 JTB401	90-6048B 90-6048B	20-65225 20-65225	20-65226 20-65226	55506 55506	219200 219200
97-02	TJ Wrangler	4.0" / 4.0"	33"x12.50"	K3056B (3,5,7) K3056BMX (3,5,7)	55495B 55495B	55497	55498	324515 6021	324509 MX6023	JTB400 JTB400	55300 55300	JTB401 JTB401	90-6048B 90-6048B	20-65225 20-65225	20-65226 20-65226	55506 55506	219200 219200

- Rear pinion adjustment cams P/N 20-65225 can be used for tuning pinion angle for minor driveline vibration correction.
- Removal of front skid plate on vehicles with automatic transmissions is required for driveshaft clearance when transfer case lowering hardware is used.
- Coil spacer P/N 55496 can be used to increase front ride height by 1" when additional accessories (winch, winch bumper, trail equipment) are added.
- P/N 90-6048B contains 16 bushings and 8 bushing sleeves.
- Box kit P/N 55699B, includes Pro Comp Suspension's latest one-piece front track bar drop, P/N 55300B, adjustable front track bar and a drop pitman arm. 03-06 models only.
- 1. Box kit P/N 55499B, adds Pro Comp Suspension's exclusive cross link braced front track bar drop and a drop pitman arm. 97-02 models only.
- 2. All ride height increases are approximate and will vary due to vehicle specifications (engine size, factory suspension options , trail equipment, etc).
- 3. Driveline modifications may be required for height increases over 2" due to increased driveline angles.
- 4. Add "G"to the end of crawler bumper P/N for gunmetal gray finish.
- 5. Front and rear lower arms, transfer case lowering hardware, and extended sway bar links included in all 4" box kits.
- 6. Transfer case lowering hardware kit P/N 55589 (97-02 only) can be used for minor driveline vibration correction.
- 7. Optional steering stabilizer available P/N 219200.

New for 2007 TJ Stage II Suspension System

Pro Comp Suspension's new 4" Stage II Jeep TJ MX6 suspension lift system has features that will crawl over those other "ultimate" kits. This top end short arm kit includes new boxed construction lower control arms that can be mounted upside down for improved break-over angles. A one-piece front track bar mount with chromoly adjustable track bar provides excellent steering manners and optimum suspension articulation. The front sway bar disconnects allow for maximum articulation. These components are combined with spring rates and MX6 shocks that TJ enthusiasts worldwide have come to appreciate.



K3083BMX – 4" LIFT



K3056B – 4" LIFT



Extended Brake Line Kit
Stainless Steel Brake Line kits are designed to replace stock rubber brake hoses on vehicles with increased ride heights of 4"- 6". See page 65. P/N 7450



TJ CV rear driveshaft P/N 4042

P/N JTB401 - Adjustable Rear Track Bar

Pro Comp Suspension has the proper solution for accurate location of the rear axle and changes in pinion angle when a tail shaft kit and CV driveshaft are installed; P/N JTB401 adjustable rear track bar is made of 4130 chromoly tubing like our front track bars and uses the same aircraft quality high angle rod end to allow full articulation.





JEEP YJ WRANGLER COIL SPRING CONVERSION KITS

				Complete Kit	Kit Breakdown (included in complete kit)			Kit breakdown continued						OPTIONAL EQUIPMENT					
Year	Application	Front / Rear Ride Height ⁽¹⁾	Recommended Tire Size	ES Series or MX6 Shocks	Front / Rear Box Kit	Front Coil Springs	Tie Down Rings		Rear Coil Springs	Brake Line Kit	Pitman Arm (3)	Front Shocks x2	Rear Shocks x2	Steering Stabilizer	Crawler Bumpers Front / Rear (5)	Steering Gearbox Brace			
87-96	YJ Wrangler CSC Soft top	5.0" / 5.0"	33"x12.50"	K3052B (6,7) K3052BMX (6,7)	55099B 55099BMX	Included Included	Included Included		Included Included	Included Included	Included Included	Included Included	Included Included	Included Included	66164 / 66165 66164 / 66165	55070B 55070B			
87-96	YJ Wrangler CSC Hard top	5.0" / 5.0"	33"x12.50"	K3053B (6,7) K3053BMX (6,7)	55199B 55199BMX	Included Included	Included Included		Included Included	Included Included	Included Included	Included Included	Included Included	Included Included	66164 / 66165 66164 / 66165	55070B 55070B			
JEEP YJ WRANGLER LEAF KITS				Complete Kit															
Year	Application	Front/Rear Ride Height ⁽²⁾	Recommended Tire Size	ES Series or MX6 Shocks	Front Kit	Front (4) Springs x2	Rear Kit		Rear (4) Springs x2	Brake Line Kit	Pitman Arm (3)	Front Shocks x2	Rear Shocks x2	Transfer Case Lowering Kit	Crawler bumpers Front / Rear (5)	Steering Gearbox Brace	Steering Stabilizer		
87-96	YJ Wrangler	2.5" / 2.5"	31"x10.50"	K3061B K3061BMX	55089B 55089B	51313 51313	50070 50070		51323 51323	———— ————	———— ————	326510 MX6013	322500 MX6014	Included (6) Included (6)	66164 / 66165 66164 / 66165	55070B 55070B	219200 219200		
87-96	YJ Wrangler	4.0" / 4.0" ⁽¹⁾	33"x12.50"	K3062B K3062BMX	55089B 55089B	51413 51413	50070 50070		51423 51423	7425 7425	YJ400 YJ400	329510 MX6026	324509 MX6027	Included (6) Included (6)	66164 / 66165 66164 / 66165	55070B 55070B	219200 219200		

JEEP CJ / DJ 4WD & 2WD LEAF KITS

Year	Application	Front/Rear Ride Height ⁽²⁾	Recommended Tire Size	Complete Kit ES Series or MX6 Shocks	Kit Breakdown (included in complete kit)			Kit breakdown continued						OPTIONAL EQUIPMENT		
					Front Kit	Front Springs x2	Rear Kit	Rear Springs x2	Brake Line Kit	Pitman Arm (3)	Front Shocks x2	Rear Shocks x2	Transfer Case Lowering Kit	Crawler bumpers Front / Rear (5)	Steering Gearbox Brace	Steering Stabilizer
82-86	CJ5, CJ7 4WD	2.5" / 2.5" ⁽¹⁾	32"x11.50"	K3063 K3063MX	50010 50010	51212 51212	50020 50020	51222 51222	— —	— —	321500 MX6010	322500 MX6011	— —	66164 / 66163	55060B	220508 220508
82-86	CJ5, CJ7 4WD	4.0" / 4.0" ⁽¹⁾	33"x12.50"	K3064 K3064MX	50010 50010	51412 51412	50020 50020	51422 51422	7405 7405	CJ400 CJ400	324509 MX6031	324509 MX6031	55076 55076	66164 / 66163	55060B	220508 220508
82-86	CJ5, CJ7 4WD w/ Dana 44	2.5" / 2.5" ⁽¹⁾	32"x11.50"	K3065 K3065MX	50010 50010	51212 51212	50030 50030	51222 51222	— —	— —	321500 MX6010	322500 MX6011	— —	66164 / 66163	55060B	220508 220508
82-86	CJ5, CJ7 4WD w/ Dana 44	4.0" / 4.0" ⁽¹⁾	33"x12.50"	K3066 K3066MX	50010 50010	51412 51412	50030 50030	51422 51422	7405 7405	CJ400 CJ400	324509 MX6031	324509 MX6031	55076 55076	66164 / 66163	55060B	220508 220508
76-81	CJ5, CJ7 4WD	2.5" / 2.5" ⁽¹⁾	32"x11.50"	K3075 K3075MX	50010 50010	51212 51212	50020 50020	51222 51222	— —	— —	319500 MX6058	322500 MX6010	— —	66164 / 66163	55060B	220508 220508
77-81	CJ5, CJ7 4WD	4.0" / 4.0" ⁽¹⁾	33"x12.50"	K3067 K3067MX	50010 50010	51412 51412	50020 50020	51422 51422	7410 7410	CJ400 CJ400	324509 MX6031	324509 MX6031	55076 55076	66164 / 66163	55060B	220508 220508
76-81	CJ5, CJ7 4WD	4.0" / 4.0" ⁽¹⁾	33"x12.50"	K3068 K3068MX	50010 50010	51412 51412	50020 50020	51422 51422	— —	CJ400 CJ400	324509 MX6031	324509 MX6031	55076 55076	66164 / 66163	55060B	220508 220508
72-75	CJ5, CJ6, DJ5, 4WD/2WD	2.5" / 2.5" ⁽¹⁾	32"x11.50"	K3069 K3069MX	50010 50010	51213 51213	50030 50030	51223 51223	— —	— —	321500 MX6030	321500 MX6030	— —	— —	— —	220508 220508
69-71	CJ5, CJ6 4WD	2.5" / 2.5" ⁽¹⁾	32"x11.50"	K3070 K3070MX	50040 50040	51213 51213	50030 50030	51223 51223	— —	— —	320500 MX6030	322500 MX6030	— —	— —	— —	220508 220508
53-68	CJ5, CJ6	2.5" / 2.5" ⁽¹⁾	32"x11.50"	K3071 K3071MX	50040 50040	51213 51213	50020 50020	51223 51223	— —	— —	320500 MX6030	322500 MX6030	— —	— —	— —	220508 220508

1. Driveline modifications may be necessary.
2. All ride height increases are approximate and will vary due to vehicle specification (engine size, factory suspension options , trail equipment, etc).
3. Pitman arm is used on vehicles with power steering only.
4. Leaf spring bushings are included in P/N 55089B kit.
5. Add "G" to the end of crawler bumper P/N for gunmetal gray finish.
6. Transfer Case Tailshaft Kit P/N 4007 and CV rear driveshaft required. See sidebar.
7. Coil spring conversion kit.

System Features

- Industry #1 selling CJ/YJ lift springs
- Progressive are diamond cut springs
- Coil springs designed and rated exclusively for the YJ
- Spring rates ideally suited for heavily equipped vehicles
- YJ box kits include: front and rear track bar relocation brackets, extended sway bar links, extended bump stops, front U-bolts and transfer case lowering hardware
- 4" pitman arm available for CJ's and YJ's with power steering
- Extended braided stainless brake lines available for positive break response
- MX6 suspension packages available

K3061B - 2.5" LIFT

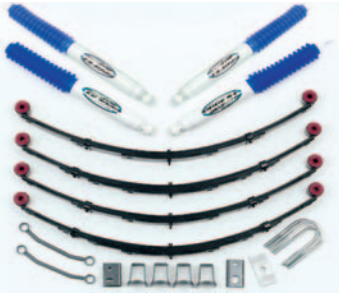

Coil Spring Conversion System Features

- 5" lift provides clearance for 33" tires on 8" wide rims
- 10" of functional wheel travel
- Coil springs designed and rated exclusively for the YJ
- Trac bar relocation brackets and dropped forged pitman arm
- Includes ES9000 shock absorbers
- MX6 suspension packages available
- ES2000 steering stabilizer included
- 4-link chromoly series control arms
- Complete bolt on installation

Coil Spring Conversion System - 5" LIFT



Hot Options!



see pages 100-108

Hot Options!



- Tailshaft conversion kit/CV rear driveshaft.
- P/N 4007 for NP231 transfer case only
 - P/N 4041 driveshaft fits 94-96 models only
 - P/N 4040 driveshaft fits 87-93 models



Crawler bumper allows steep approach and departure angles. P/N 66163 & P/N 66165.



Stylish and functional bolt-on auxiliary light bar P/N 13000. See pages 102-103 more lighting details.



Steering Brace helps support the Jeep steering box. Easy installation, complete with instructions. P/N 55060B & P/N 55070B.



Hi-capacity heat-treated aluminum front differential covers available for CJ and YJ. See differential covers page 107 for more details.

Important Ordering Notes



Premium MX6 6-way adjustable gas stabilized shock absorbers are available. See pages 74-75 for more details.



JEEP XJ CHEROKEE MID-SIZE 4WD & 2WD

				Complete Kit	Kit Breakdown (included in complete kit)			Kit breakdown continued				OPTIONAL EQUIPMENT			
Year	Application	Front/Rear Ride Height (1)	Recommended Tire Size	ES Series or MX6 Shocks	Front Kit	Front Coil Springs	Rear U-bolt Kit	Sway Bar Link Kit	Rear Kit Add-a-leaf	Front Shocks x2	Rear Shocks x2	Adjustable Front Track Bar	1" Front Coil Spacer	Steering Stabilizer	Rear Leaf Springs 3.5"-4" Lift
84-01	XJ Cherokee 4WD/2WD	3.0" / 2.0"	31"x10.50"	K3058B (3) K3058BMX	55590B	55592	50050 (2)	55597B	13120	324515	322500	JTB400	55496	219200	53111* (1,4)
					55590B	55592	50050 (2)	55597B	13120	MX6021	MX6034	JTB400	55496	219200	53111* (1,4)

JEEP ZJ GRAND CHEROKEE 4WD & 2WD

				Complete Kit	Kit Breakdown (included in complete kit)			Kit breakdown continued				OPTIONAL EQUIPMENT		
Year	Application	Front/Rear Ride Height (1)	Recommended Tire Size	ES Series or MX6 Shocks	Front / Rear Box Kit	Front Coil Springs	Rear Coil Springs	Sway Bar Link Kit	Rear Kit Add-a-leaf	Front Shocks x2	Rear Shocks x2	Adjustable Front Track bar	1" Front Coil Spacer	Steering Stabilizer
92-98	ZJ Grand Cherokee 4WD/2WD	3.0" / 2.5"	31"x10.50"	K3059B (3) K3059BMX	55591B	55598	55593	55597B	—	324515	324509	JTB400	55496	219200
					55591B	55598	55593	55597B	—	MX6021	MX6032	JTB400	55496	219200

1. All ride height increases are approximate and will vary due to vehicle specification (engine size, factory suspension options , trail equipment, etc).
 2. Cherokees are equipped with different diameter rear axles. Use P/N 50055 rear U-bolts for 2.75" diameter. P/N 50050 for 3.25" diameter. Please determine axle dimensions before ordering.
 3. Vehicles equipped with light duty, double offset joint (rubber boot) front driveshafts must be replaced with Spicer constant velocity (CV) type if driveline vibration occurs. Additional driveline modifications may be required for height increases over 2".
 4. Coil spacer P/N 55496 can be used to increase front ride height by 1". Recommended for Cherokee when using P/N 53111 rear springs.
- * Replacement rear spring bushings P/N 90-3801 are sold as a set for one P/N 53111 spring.

Important Ordering Notes



Hi-capacity heat-treated aluminum rear differential covers available for Dana 35 rear axle. See differential page 107 for more details.



Ideally suited to level your vehicle. In stock form or for vehicles with winches, snow plows, motor conversions, etc. Sold in pairs. P/N 55496. See page 70.



Optional leaf springs raise the rear 3.5"-4". P/N 53111 See leaf spring page 71 for more details.

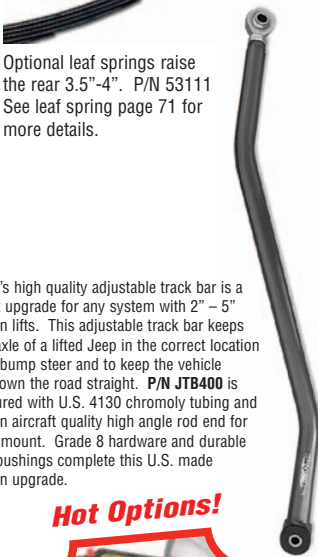

Pro Comp's high quality adjustable track bar is a trail smart upgrade for any system with 2" – 5" suspension lifts. This adjustable track bar keeps the front axle of a lifted Jeep in the correct location to reduce bump steer and to keep the vehicle tracking down the road straight. P/N JTB400 is manufactured with U.S. 4130 chromoly tubing and includes an aircraft quality high angle rod end for the frame mount. Grade 8 hardware and durable urethane bushings complete this U.S. made suspension upgrade.

Hot Options!



see pages 100-108



Premium MX6 6-way adjustable gas stabilized shock absorbers are available.



K3058B - 3" LIFT



K3059B - 3" LIFT

Pro Comp Suspension System Features

The original midsize Cherokee XJ and Grand Cherokee ZJ have become very popular among the enthusiast off road crowd because of their competence and comfort. These vehicles off road capability can be improved without high dollar modifications. Pro Comp offers affordable systems that include tubular chromoly lower control arms that glide over rocks. These arms use unique, reverse hour-glass urethane bushings that increase off-road articulation and do not compromise on road handling. Ideal spring rates combined with optional mono-tube adjustable MX6 shock absorbers or twin tube hydraulic shocks provide excellent road and trail manners. Necessary components like a front track bar relocation bracket and extended sway bar links complete trail worthy packages that can make it a little easier to reach your off road destination.